

Hardware included

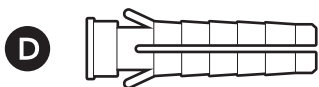

Tools needed

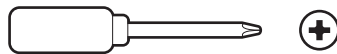

Phillips-head screwdriver

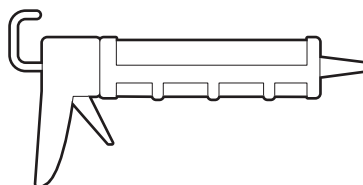

Caulk gun

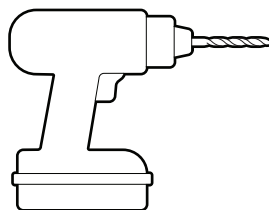

Drill with a 6 mm (1/4 in) masonry bit (optional)

1.

Remove the protective wrap.



2.

Download the Ring app.



3.

Scan the QR code on your device.

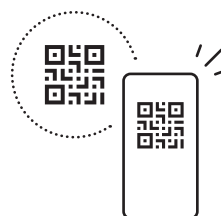

4.

Choose a location.

NOTE: Before installation, ensure your Power over Ethernet (PoE) switch or injector capable of PoE+ is active and connected to a functioning Category 5 or above Ethernet cable.

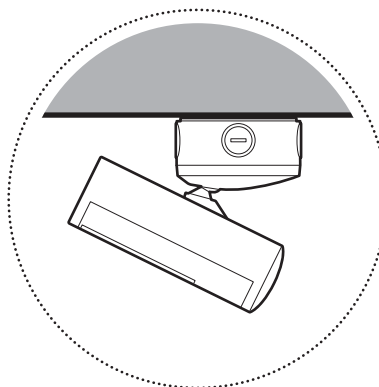
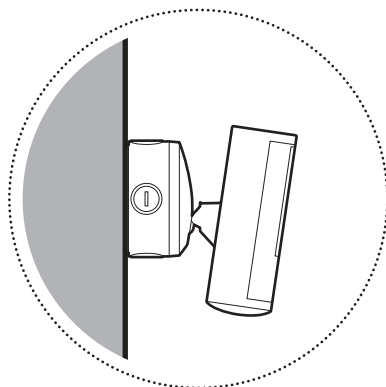

Junction box installation

1.

Use a coin to unscrew a cap from the side or back of the junction box for the Ethernet cable, depending on where the Ethernet cable enters the junction box.

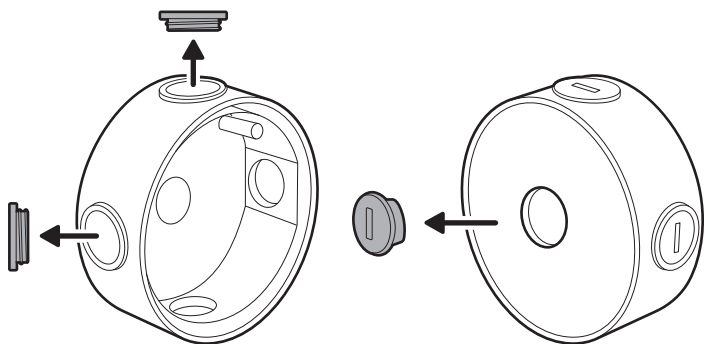

2.

Install the included junction box on the wall or ceiling with the included screws.

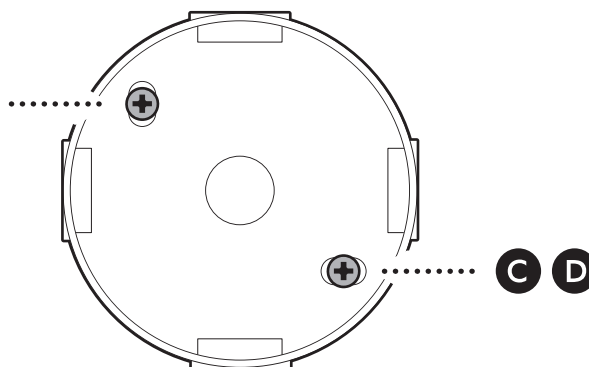

On stucco, brick, or concrete, use a 6mm (1/4 inch) masonry bit to drill holes for the included wall anchors.

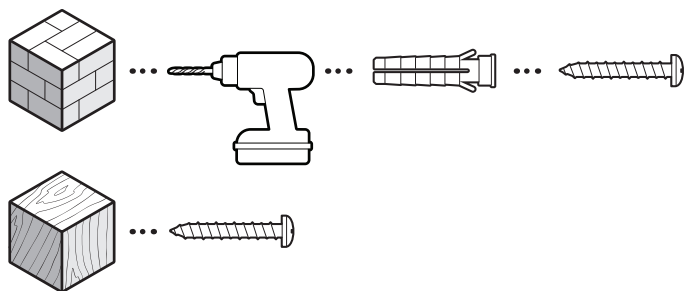

3.

Cover the screw holes with the included rubber caps.

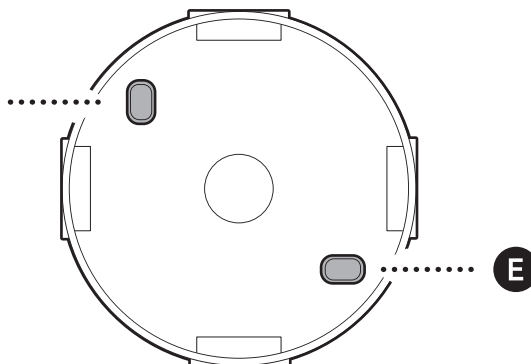

4.

Disassemble the cable gland by unscrewing the cap from the body.

NOTE: If the Ethernet cable is entering the junction box through the back, you do not need to attach the cable gland.

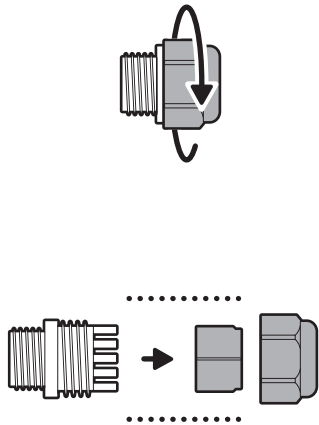

5.

Thread the Ethernet cable through the cable gland, wrapping the O-ring around the cable, and screw tightly until there is a secure seal.

NOTE: If installing the junction box directly over your PoE switch, you do not need to attach the cable gland.

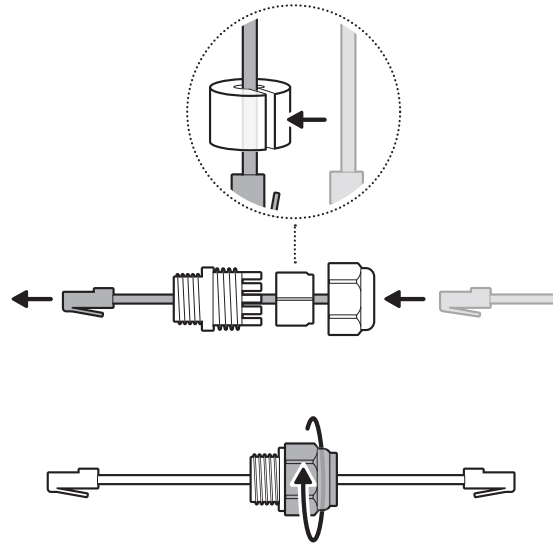

6.

Insert the Ethernet cable through the knockout, ensuring the cable gland is snug.

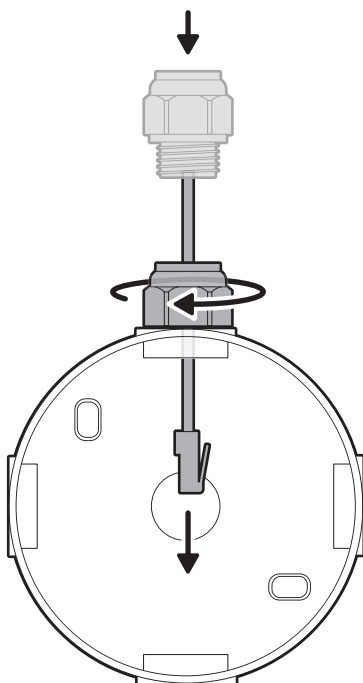

7.

Plug the Ethernet cable into the adapter.

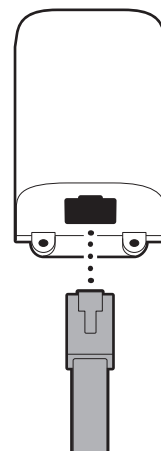

8.

Plug the USB-C cable within the junction box cover mount into the adapter, ensuring it is fully inserted.

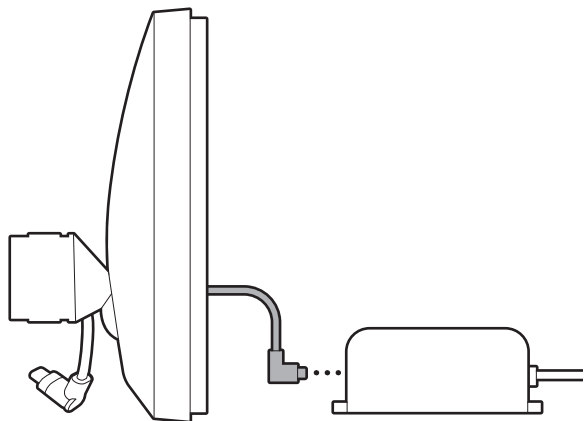

9.

Slot the adapter into the center of the junction box.

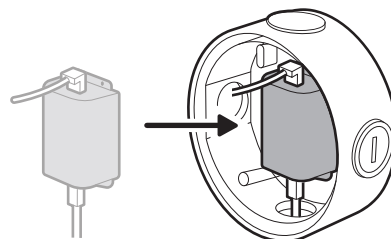

10.

Attach the metal crossbar with the screws included with your adapter, starting with the closed screw hole.

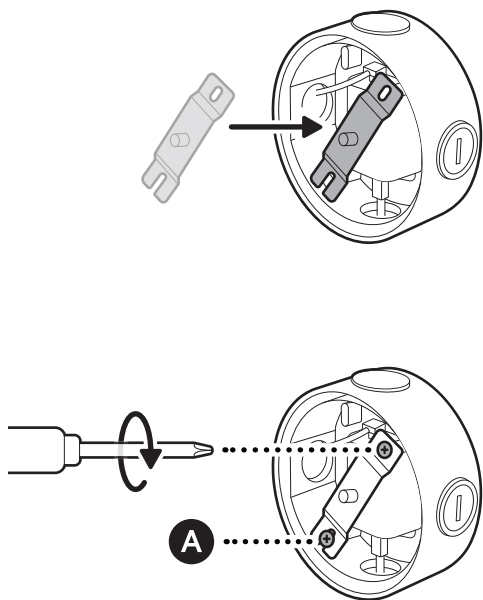

11.

Close the junction box with the cover mount.

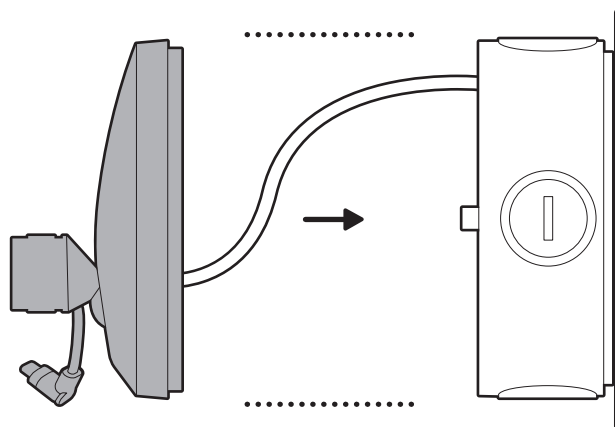

12.

Tighten the center screw to secure the junction box cover mount in place.

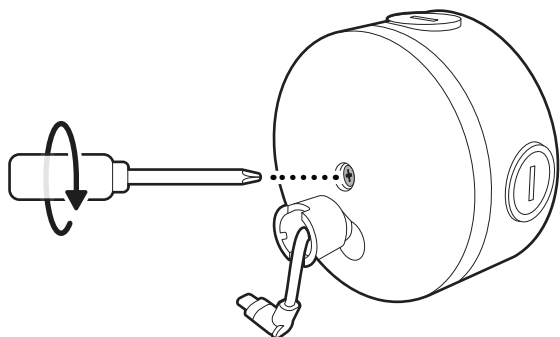

13.

Cover the center screw hole with the included rubber cap.

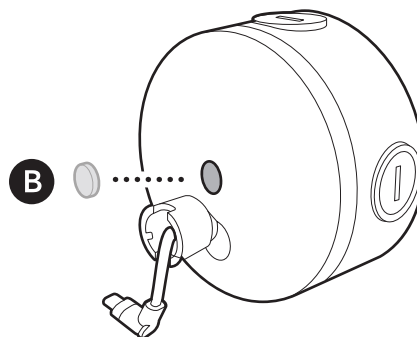

14.

Remove the middle rubber cap on the back of your camera.

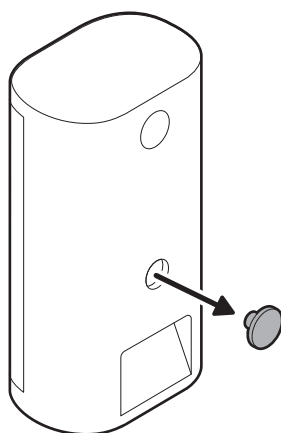

15.

Tighten the included hex joint onto the back of your camera, ensuring the UP indicator is pointing up.

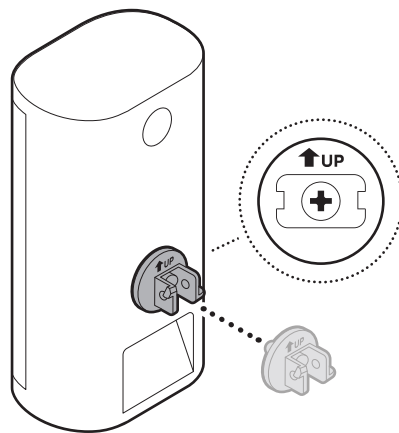

16.

Plug the USB-C cable on the junction box cover mount into your camera, ensuring it is fully inserted.

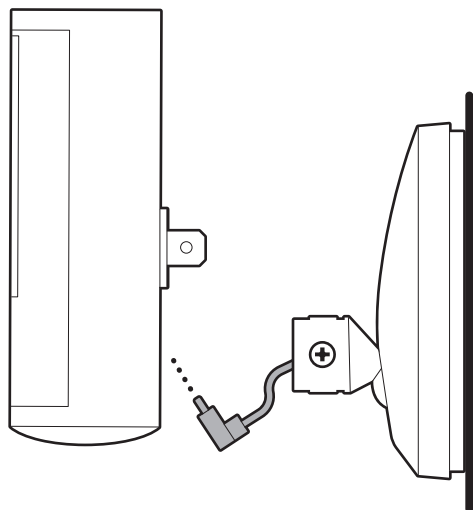

17.

Align the hex joint with the junction box cover mount and insert.

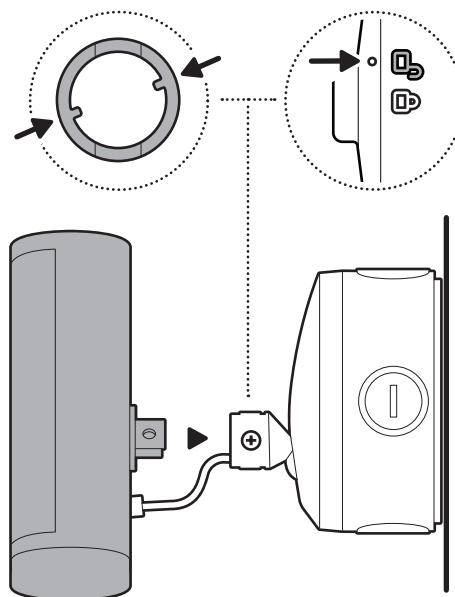

18.

Turn until your camera locks in place.

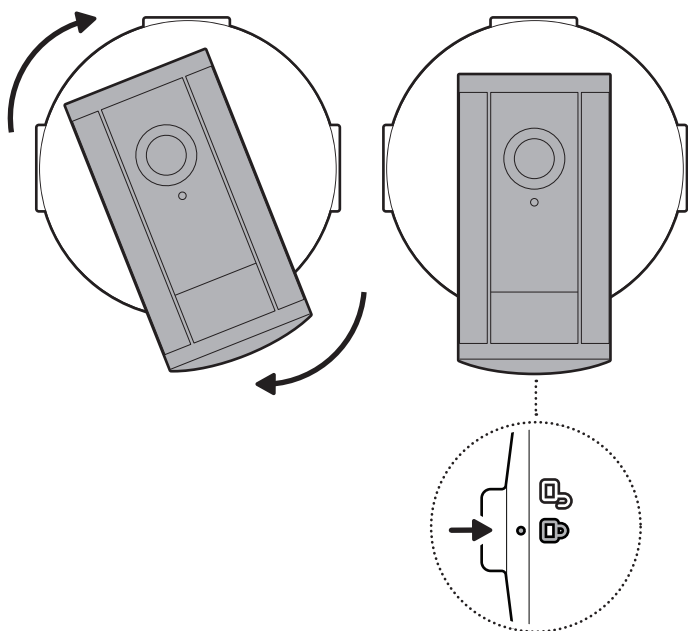

19.

Tighten the security screw.

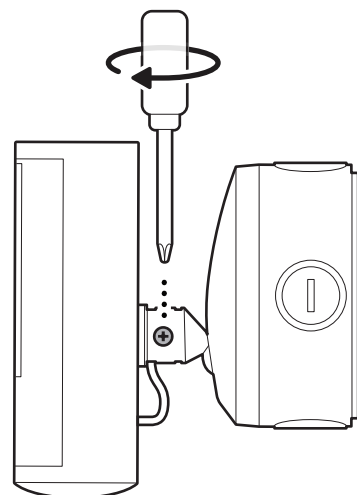

20.

Install your camera's decorative cover by sliding until you hear a click to secure.

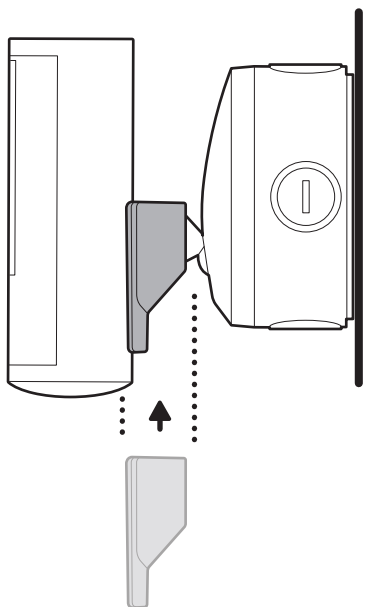

21.

Adjust your camera's position, if necessary.

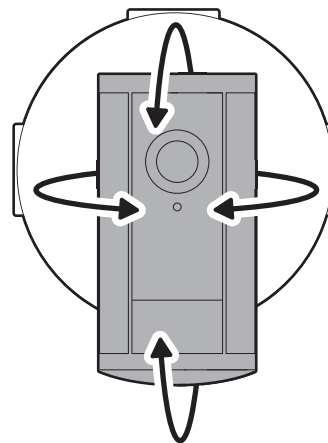

22.

Must apply proper silicone or caulk around the junction box knockouts, between the junction box and junction box cover mount, and between the junction box and mounting surface to seal any gaps.

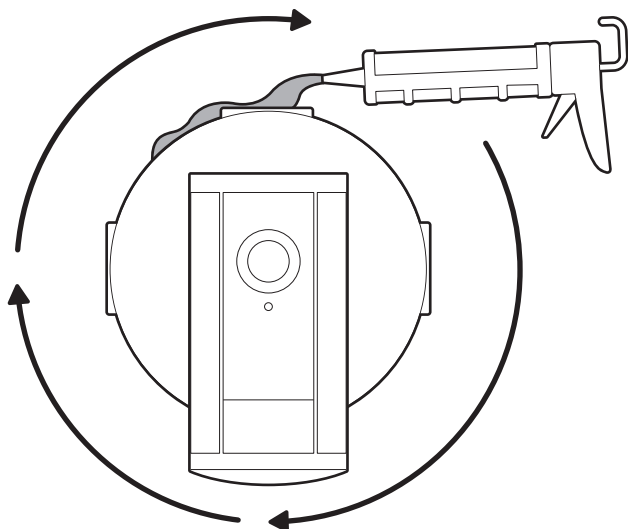

ring.com/contact



ring.com/help

Ring LLC 12515 Cerise Ave, Hawthorne, CA, 90250 USA

Ring LLC / Amazon EU S.à.r.l., 38 Avenue John F. Kennedy, L-1855
Luxembourg / Amazon UK, 1 Principal Place, Worship Street,
London, EC2A 2FA, United Kingdom

アマゾンジャパン合同会社〒153-0064 東京都目黒区下目黒1-8-1

شركة Ring LLC طريق سيريس مبنى 12515 مدينة هاولتون، كاليفورنيا،
90250، الولايات المتحدة الأمريكية.

©2025 Ring LLC or its affiliates. Ring and all related
marks are trademarks of Ring LLC or its affiliates.

©2025 Ring LLC又はその関連会社。Ring及びこれらに関するすべての商標
は、Ring LLC又はその関連会社の商標です。