

Hardware included

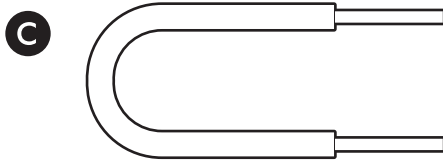

Tools needed

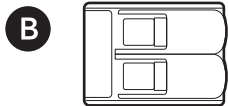
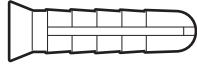
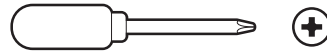

Phillips-head screwdriver

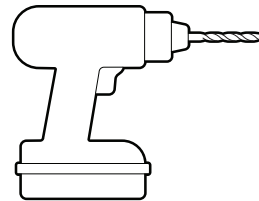

Drill with a 1/4 in (6 mm) masonry bit (optional)

1.

Remove the protective wrap.



2.

Download the Ring app.



3.

Scan the QR code on your device.

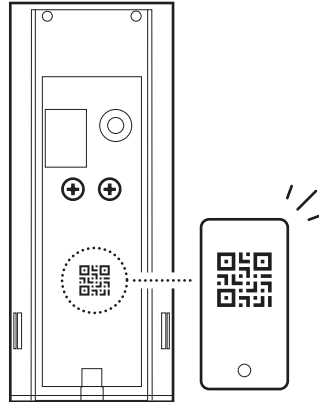

Doorbell installation

1.

Shut off power at the breaker.

NOTE: If you are unsure which breaker to flip, turn off the master breaker or contact an electrician.



CAUTION!

You'll be working with electrical wires during the install process.

If you are uncomfortable or inexperienced with doing so, consult with a licensed electrician.

Do not wire your Ring Doorbell to a DC-powered intercom system.

WARNING!

If your home has multiple chimes, you will need to ensure any additional chimes are bypassed by connecting the wires connected to Front and Trans together with a wire nut.

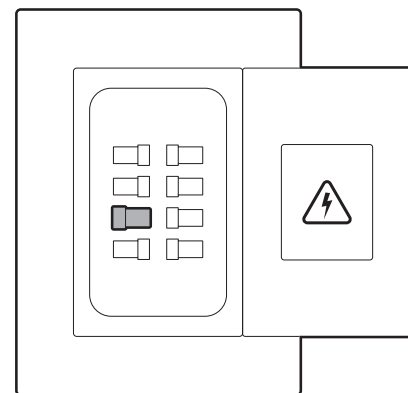

2.

Remove your doorbell chime's cover.

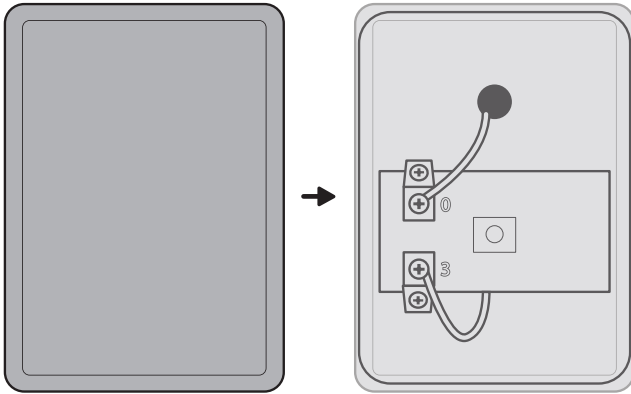

3.

Loosen the terminal screw marked "0" and disconnect its wire. Insert the wire into a wago connector.

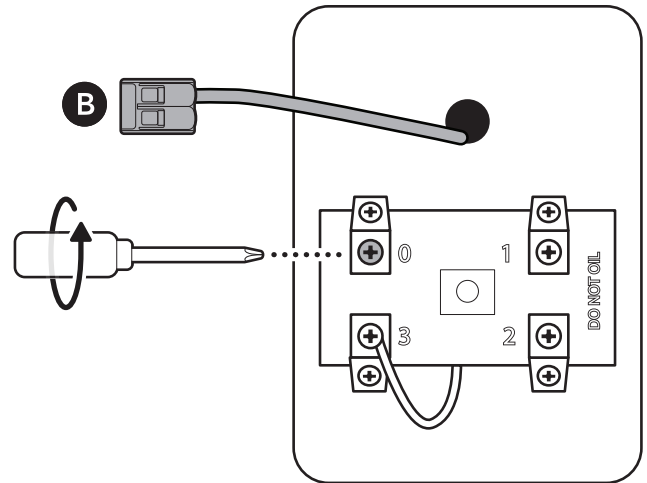

4.

Loosen the terminal screw marked "2" or "3" and disconnect its wire. Insert the wire into the other wago connector.

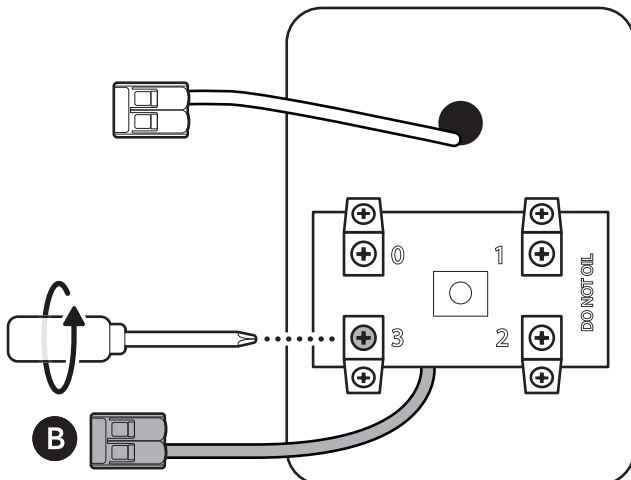

5.

Connect the wago connectors together with the bypass wire.

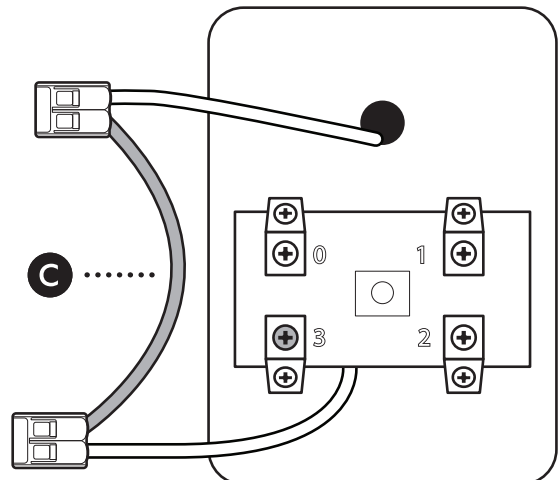

6.

Locate your existing doorbell and remove.

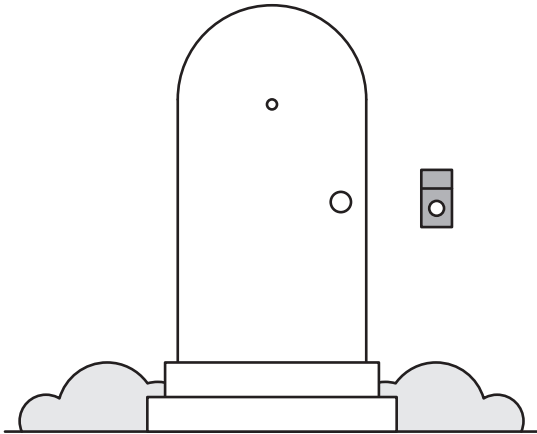

7.

Use the mounting bracket as a guide to mark screw holes on the wall.

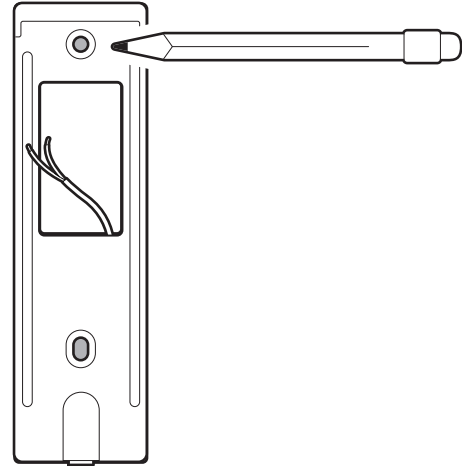

8.

Install the mounting bracket directly over your doorbell wiring with the included screws.

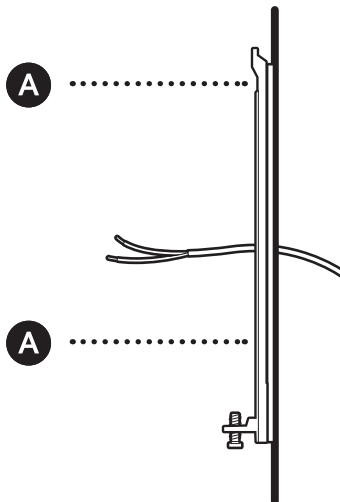

Note: On stucco, brick, or concrete, use a 1/4 in (6 mm) masonry bit to drill holes for the included wall anchors.

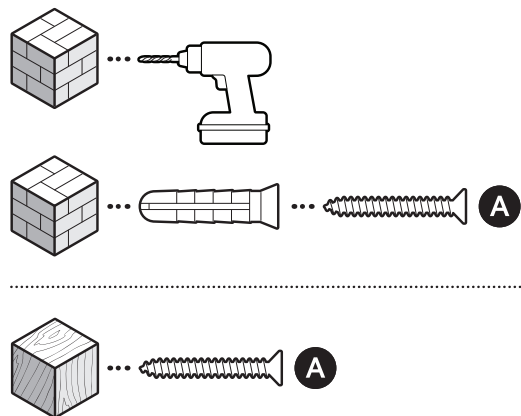

9.

Connect the doorbell wiring to your doorbell's wire terminals.

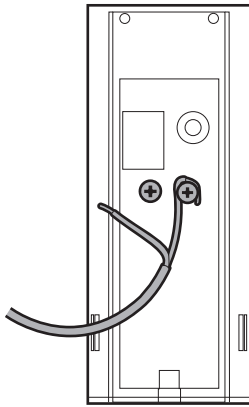

10.

Mount your doorbell by hooking it over the bracket.

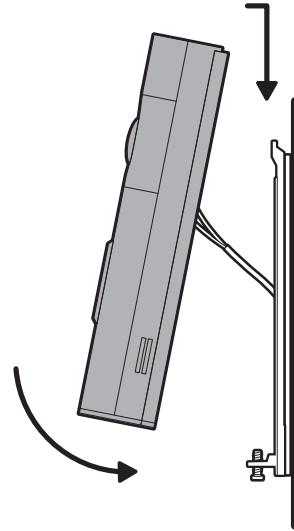

11.

Tighten the security screw.

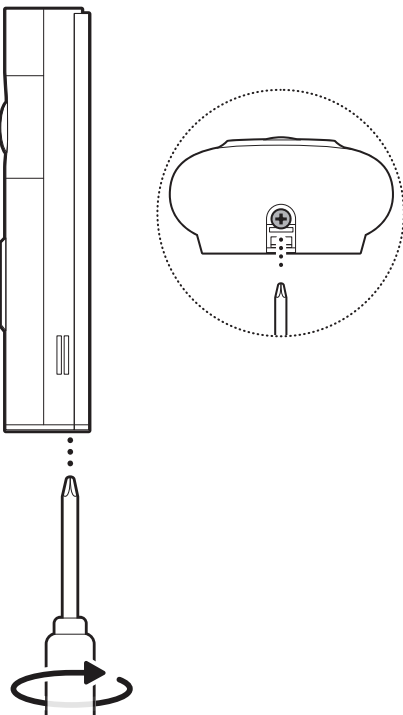

12.

Restore power at the breaker.

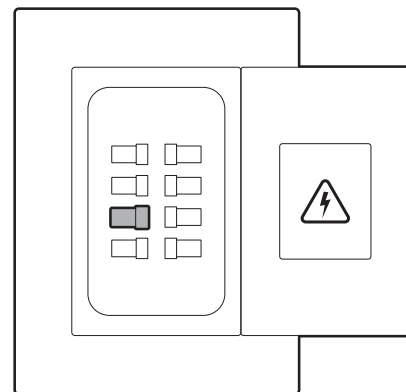

 ring.com/contact

 ring.com/help

Ring LLC 12515 Cerise Ave, Hawthorne, CA, 90250 USA

Ring LLC / Amazon EU S.à.r.l., 38 Avenue John F. Kennedy, L-1855 Luxembourg / Amazon UK, 1 Principal Place, Worship Street, London, EC2A 2FA, United Kingdom

©2026 Ring LLC or its affiliates. Ring and all related marks are trademarks of Ring LLC or its affiliates.
